



TheOfficialSMDC www.smdc.com

HLURB TLS ENCRFO 15-06-013 | ENCR AA-2015/08-836

Lot 3-C, Seaside Boulevard & Sunrise Drive, Mall of Asia Complex, Pasay City

Completion Date: December 2019

Owner/Developer: SM Development Corporation

Shore 2
RESIDENCES
MALL OF ASIA COMPLEX



A PRIVATE ISLAND CALLED HOME

No passports, no visas, no luggage, - paradise is right here at Shore 2 Residences. Soak up the sun in pools stretched throughout the amenity deck, stroll through the landscaped gardens or indulge in the luxury of doing absolutely nothing. It's your island, your rules.

Amenity Area, Artist's Perspective



Building Facade, Artist's Perspective

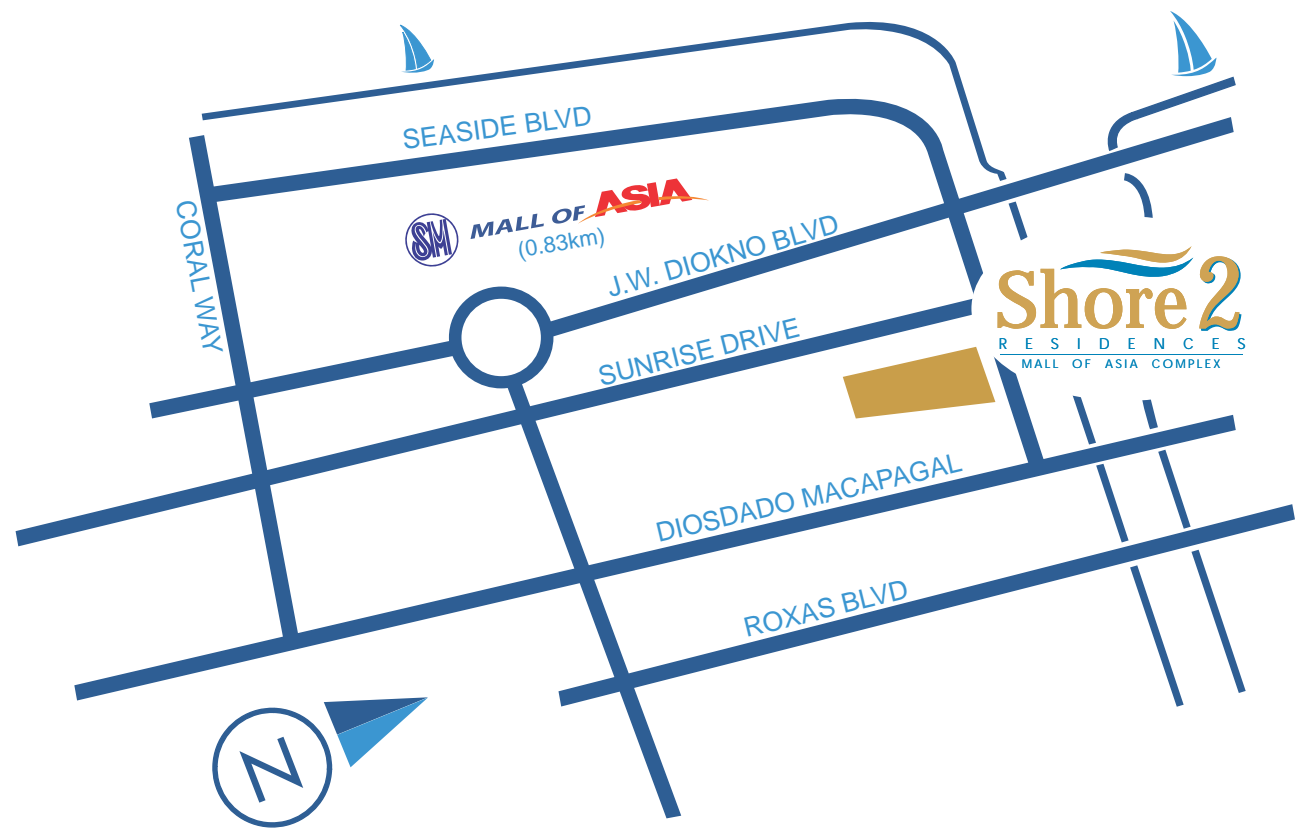

- MOA Terminal (0.6 km)
- MRT EDSA Station (1.6 km)
- LRT Taft Avenue (1.6 km)



- SM Mall of Asia (0.8 km) ?
- S&R (1.4 km) ?
- Blue Bay Walk (0.7 km) ?
- Seaside Market (0.4 km)



- One E-com Center (0.5 km) ?
- Two E-com Center (0.4 km) ?
- Five E-com Center (0.3 km) ?
- SMX Convention Center (1.2 km) ?
- World Trade Center (1 km)



- Solaire Resort and Casino (2 km) ?
- City of Dreams (2 km) ?
- SM MOA Arena (1.1 km) ?
- One Esplanade (0.3 km) ? CCP (1.8 km) ?
- Microtel (1.3 km) ?
- Heritage Hotel (1.1 km) ?
- Sofitel (1.4 km) ?



- Manila Tylana College (0.3 km) ?
- De La Salle University (2.7 km) ?
- College of St. Benilde (2.7 km) ?
- St. Scholastica's College (2.8 km) ?



- San Juan De Dios (1 km) ?
- Manila Adventist Medical Center (1.9 km) ?
- Ospital ng Maynila (2.5 km) ?
- Pasay General Hospital (1.9 km)

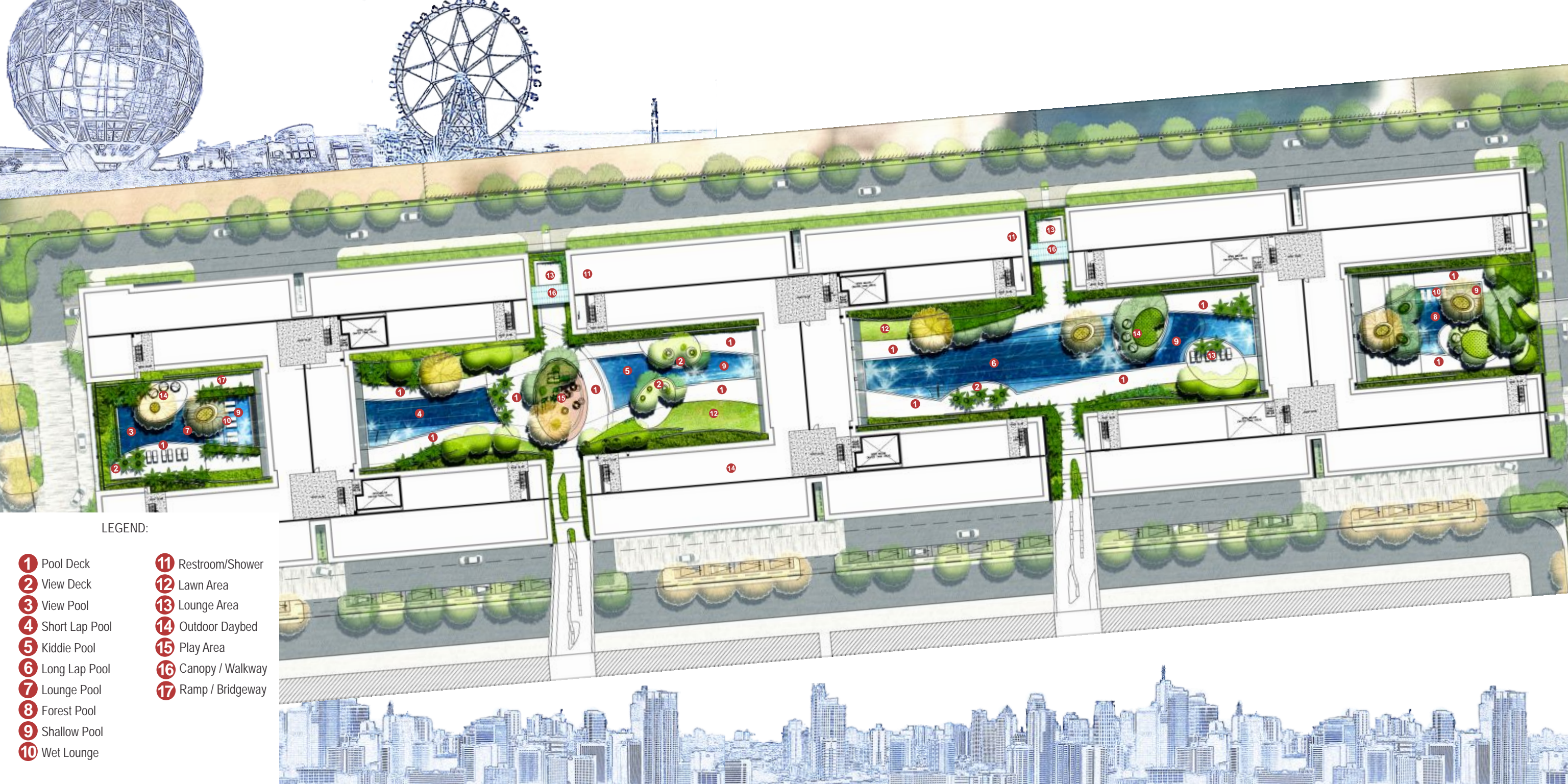

LEGEND:

- | | |
|------------------|---------------------|
| 1 Pool Deck | 11 Restroom/Shower |
| 2 View Deck | 12 Lawn Area |
| 3 View Pool | 13 Lounge Area |
| 4 Short Lap Pool | 14 Outdoor Daybed |
| 5 Kiddie Pool | 15 Play Area |
| 6 Long Lap Pool | 16 Canopy / Walkway |
| 7 Lounge Pool | 17 Ramp / Bridgeway |
| 8 Forest Pool | |
| 9 Shallow Pool | |
| 10 Wet Lounge | |



EXPERIENCE

Enjoy the island breeze with the pools stretched throughout the amenity deck. Each pool area has a different private island vibe for you to experience.



Amenity Area, Artist's Perspective



Entry Deck, Artist's Perspective

RELAX

Embrace luxury in stylish lounges that exude an idyllic ambiance. The relaxed vibe of resort living can be felt in the grand lobbies and entry decks. Inspired by island resort hideaways, its interiors and furnishings incorporate colors and features of natural island elements with a tropical chic sophistication.



Grand Lobby, Artist's Perspective



VIEW 2BR Suite

Revel in special units that offer a new perspective of "island living" in the city. Unique to this development are units that protrude from the building façade. With floor to ceiling windows, these units offer views of the superb sunsets of Manila Bay, and the glossy lights of the city skyline.

Model Unit, Artist's Perspective



Model Unit, Artist's Perspective



LIVE 1BR w/ Balcony

Delight in blissful solitude or vibrant socials in your very own paradise. Choose from 2BR and 1 BR units that complement your lifestyle. Truly, there's nothing quite like having your own personal paradise.

Model Unit, Artist's Perspective



Every single day, SM touches the lives of millions of people through its stores, malls, banks, hotels and leisure facilities. And now, Filipinos can live in style, comfort and convenience at SM Development Corporation (SMDC).

SMDC commits itself to provide access to luxurious urban living through vertical villages perfectly integrated with a commercial retail environment, giving its residents a truly cosmopolitan lifestyle.

SMDC developments are strategically situated in key areas across Metro Manila specifically the Central Business Districts of Makati, Ortigas, Quezon City, Pasay and Parañaque.